



Ducie Street, Clapham, SW4

2 bedroom flat to let

£484 Per Week

Part furnished

Property Details

Keating Estates are delighted to present this charming two-bedroom conversion flat, set within an attractive Victorian building on the sought-after Ducie Street. Positioned at the front of the property are two well-proportioned double bedrooms and a stylish shared bathroom. A central hallway leads through to the rear, opening into a spacious and airy open-plan kitchen and reception room perfect for entertaining or relaxing. This bright living area flows seamlessly out to a private courtyard garden, ideal for enjoying outdoor space in a peaceful setting. Ideally located, the flat is just a seven-minute walk from both Brixton and Clapham North underground stations, offering excellent transport links. Residents will enjoy the vibrant lifestyle of Brixton, with Pop Brixton, eclectic markets, and a wide array of shops, cafes, and restaurants all within easy reach.

Features

- Two bedrooms
- Open Plan
- Private Garden
- Victorian conversion
- Bright and airy
- Close to Central Brixton
- Close to transport links

Council tax band D EPC rating D (65)



Ducie Street, Clapham, SW4

Ducie Street

Ground Floor

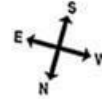
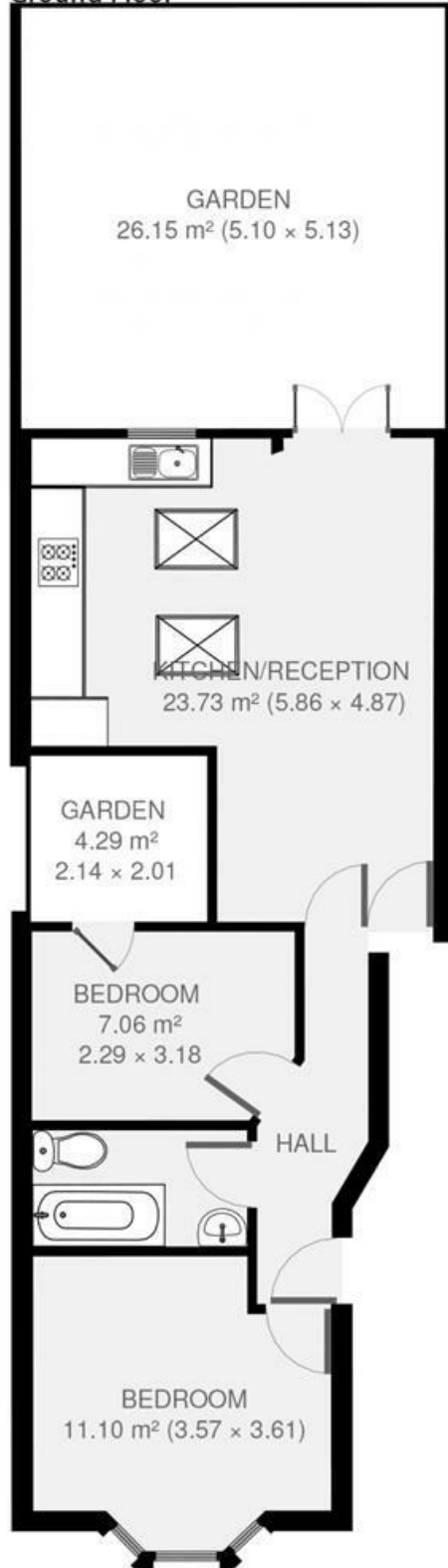

2 bed Flat.

Approx internal area:

614 sqft 57 sqm

While we do try our very best, floor plans are produced as a guide only and we take no responsibility for the precise accuracy with which any property is represented

Ducie Street, Clapham, SW4

